

EIX Conference Hall

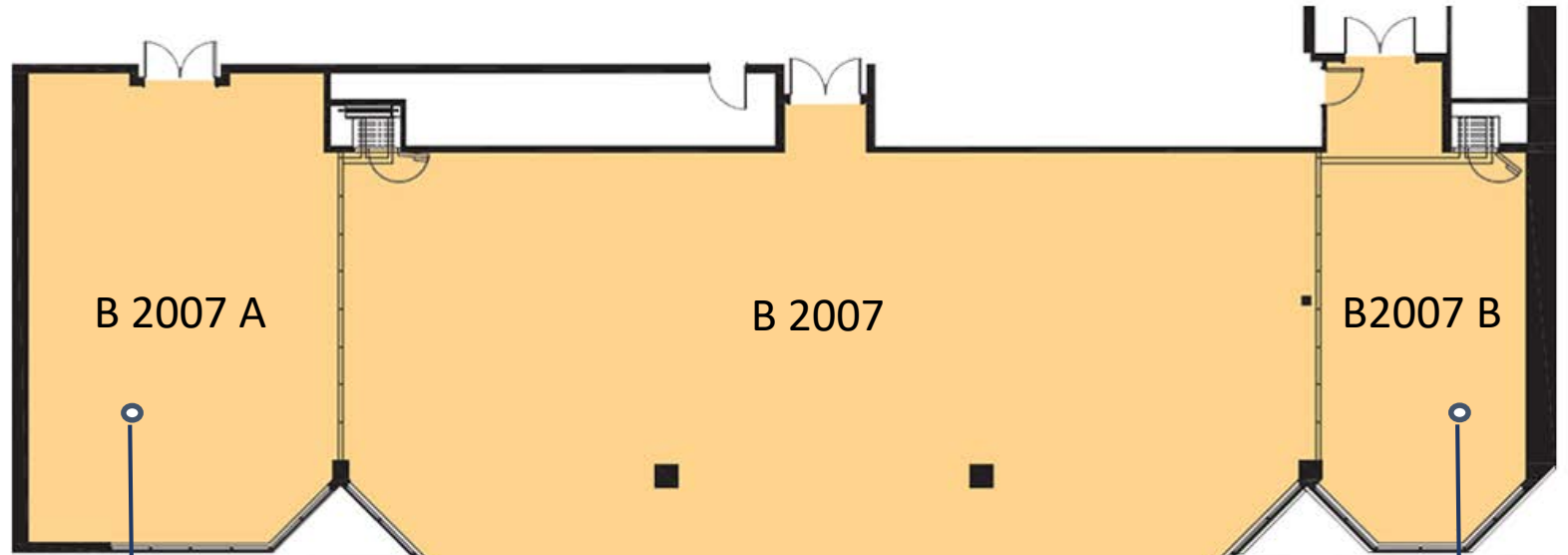
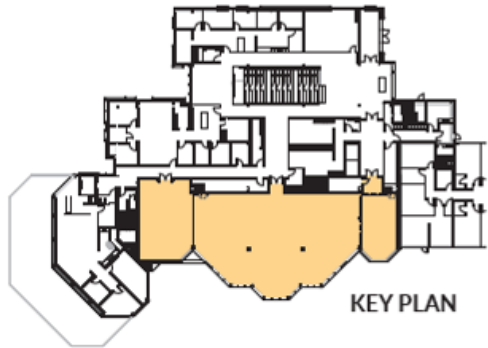

CITY SIDE

Area: 1000 sqft
Height: 9'-10"
Capacities
Banquet: 48
Reception: 58
Theatre: 58
Classroom: 40
Boardroom: 38

BASE RATE
\$700/day
\$350/half day
\$90/hourly

MAIN

Area: 3450 sqft
Height: 9'-10"
Banquet: 176 Reception: 300
Theatre: 250 Classroom: 170

BASE RATE
\$1,200/day
\$600/half day
\$160/hourly

HILL SIDE

Area: 615 sqft
Height: 9'-10"
Capacities
Banquet: 24
Reception: 40
Theatre: 48
Classroom: 20
Boardroom: 20

BASE RATE
\$500/day
\$250/half day
\$70/hourly

CITY SIDE + MAIN + HILL SIDE

Area: 5065 sqft
Height: 9'-10"
Banquet: 240 Reception: 450
Theatre: 280 Classroom: 250

BASE RATE

\$ 2,200/day | \$ 1,100/half day | \$ 300/hourly

Update: January, 2021

Prices in Canadian Dollars, plus 15% tax