

EIX Conference Hall

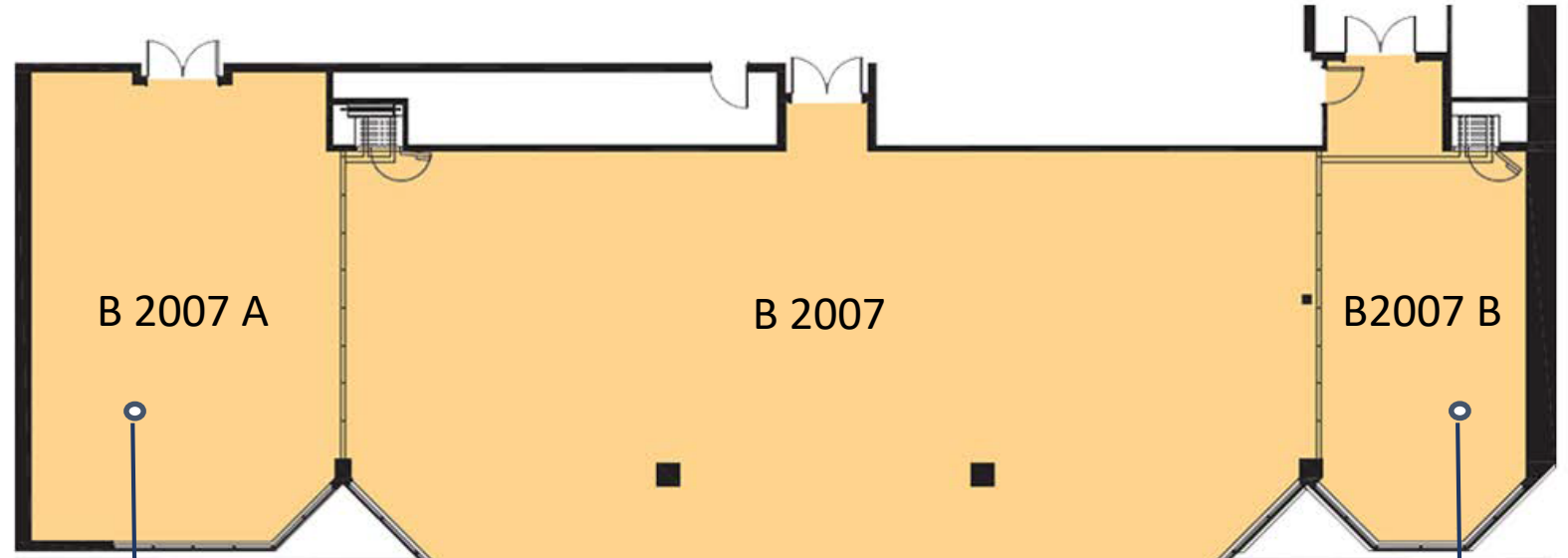

CITY SIDE
 Area: 1000 sqft
 Height: 9'10
 Capacities
 Banquet: 40
 Reception: 50
 Theatre: 50
 Classroom: 36
 Boardroom: 18
 Cabaret: 36

BASE RATE
 \$750/day
 \$375/half day
 \$100/additional hour

MAIN
 Area: 3450 sqft
 Height: 9'-10
 Banquet: 136
 Theatre: 216
 Classroom: 102
 Cabaret: 102

Banquet: 136 Reception: 300
 Theatre: 216 Classroom: 102
 Cabaret: 102

BASE RATE
 \$1,300/day
 \$650/half day
 \$170/additional hour

HILL SIDE
 Area: 615 sqft
 Height: 9'10
 Capacities
 Banquet: 24
 Reception: 30
 Theatre: 30
 Classroom: 24
 Boardroom: 14
 Cabaret: 24

BASE RATE
 \$550/day
 \$275/half day
 \$75/additional hour

CITY SIDE + MAIN + HILL SIDE
 Area: 5065 sqft
 Height: 9'-10
 Banquet: 208
 Theatre: 280
 Reception: 400

BASE RATE
 \$ 2,300/day | \$ 1,150/half day | \$ 300/additional hour

Update: April 1, 2023

Prices in Canadian Dollars, plus 15% tax

*Please note capacities are estimates and may change based on set-up requirements.